

### SERVO MOTOR 055EDC300BFCRA063110

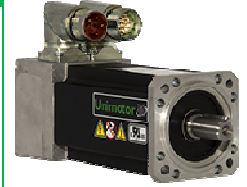

#### Definition

Type	<b>Unimotor HD</b>	
Frame Size (mm)	<b>055</b>	
Voltage	<b>E</b>	E - 220V
Magnet type	<b>D</b>	D - High dynamic
Frame Length	<b>C</b>	
Speed (min-1)	<b>30</b>	3000
Brake	<b>0</b>	Unbraked (0)
Connection type	<b>B</b>	B - Power and Signal 90° rotatable
Output shaft	<b>F</b>	Both key fitted
Feedback device code	<b>CR</b>	CR - 4096 ppr Incremental encoder (R35i)
Inertia & thermistor	<b>A</b>	A - Standard
PCD	<b>063</b>	063 (FF 63 / 40)
Shaft Diameter	<b>110</b>	11j6 x 23,0 .
Fan box	<b>-</b>	
Classe d'isolation	<b>F</b>	
UL Motor / UL Stator	<b>UL Motor / UL Stator</b>	

#### Nominal characteristics

Motor Ambient Temperature (°C)	40	Drive Fsw (kHz)	12
Motor Stall Torque (N.m)	1,65	Stall Current (A)	1,80
Rated Torque (N.m)	1,48	Rated Current (A)	1,6
Motor Peak Torque (N.m)	6,60	Peak Current for Drive Selection (A)	7,26
Rated Power (kW)	0,46	Kt (Nm/A)	0,91
Winding Thermal Time Constant (s)	42	Ke (V/kmin-1)	55,00
Number of Poles	8	R (ph-ph) (Ohm)	9,53
Maximum Cogging (N.m)	0,075	L (ph-ph) (mH)	23,00
Inertia (kg.cm <sup>2</sup> )	0,36	Peso del prodotto	2,44
Ingress Protection Level (IP)	IP65		

#### Torque / speed graph

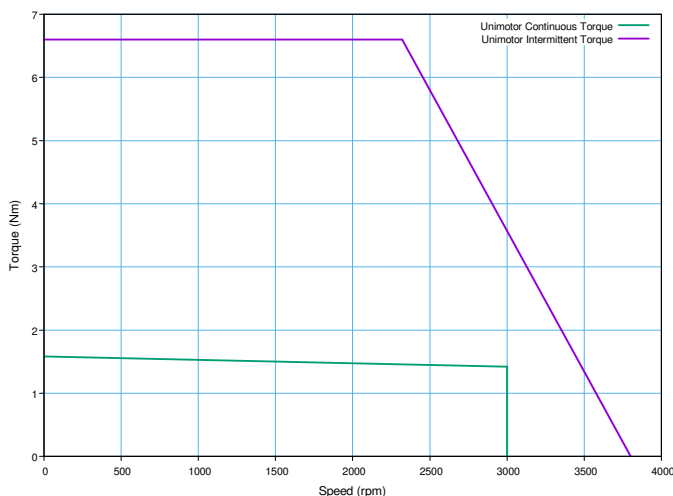

#### Configured characteristics

Motor Ambient Temperature (°C)	40
Drive Fsw (kHz)	8
Derating Factor	0,96
Stall Torque with Derating Factor (N.m)	1,58
Nominal Torque after Derating (N.m)	1,42
Peak Torque with Derating Factor (N.m)	6,60

### SERVO MOTOR 055EDC300BFCRA063110 - Unimotor HD 055EDC300BFCRA063110

#### Motor (° & mm)

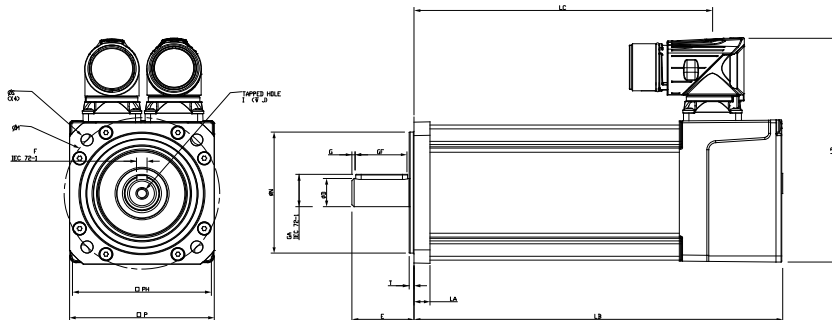

LB	Total length	166,30
LB1		
LC	Power connector position	138,00
LJ		
LA	Flange thickness	7,0
T	Register Length	2,5
N	Register Diameter	40,0
LD	Power connector overall height	99,00
LD1		
P	Flange Square	55,0
S	Fixing Hole Diameter	5,8
M	Fixing hole PCD	63
PH	Motor Housing Width	55
D	Shaft Diameter	11j6
E	Shaft Length	23,0
GA	Key Height	12,5
GF	Key Length	18,0
G	Key to Shaft End	1,0
F	Key Width	4 h9
I	Tapped Hole Thread Size	M4x0.7
J	Tapped Hole Depth	10,0
	Mounting Bolt	M5

#### Motor electrical interface

Feedback device code : CR - 4096 ppr Incremental encoder (R35i)

Connection type :  
Section des fils :

B - Power and Signal 90° rotatable  
4G1

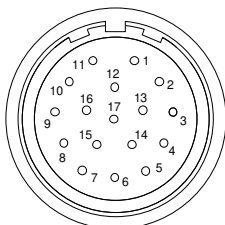

- |          |              |
|----------|--------------|
| 1 - CTP  | 10 - A       |
| 2 - CTP  | 11 - Index   |
| 3 -      | 12 - Index / |
| 4 - S1   | 13 - A /     |
| 5 - S1 / | 14 - B       |
| 6 - S2   | 15 - B /     |
| 7 - S2 / | 16 - Power   |
| 8 - S3   | 17 - 0V      |
| 9 - S3 / | Screen       |

- U - Phase U  
V - Phase V  
W - Phase W  
Screen

- B+ - Brake +  
B- - Brake -

