

### SERVO MOTOR 075U3A306BAECA075110



### Definition

Type	<b>Unimotor FM</b>	
Frame Size (mm)	<b>075</b>	
Voltage	<b>U</b>	U - 400V
Magnet type	<b>3</b>	3 - Standard
Frame Length	<b>A</b>	
Speed (min-1)	<b>30</b>	3000
Brake	<b>6</b>	Braked (6)
Connection type	<b>B</b>	B - Power and Signal 90° rotatable
Output shaft	<b>A</b>	Key
Feedback device code	<b>EC</b>	EC - Inductive EnDat SinCos Multi-Turn (EQI 1331)
Inertia & thermistor	<b>A</b>	A - Standard
PCD	<b>075</b>	075 (FF 75 / 60)
Shaft Diameter	<b>110</b>	11j6 x 23,0 .
Fan box	<b>-</b>	
Classe d'isolation	<b>F</b>	
UL Motor / UL Stator	<b>UL Motor / UL Stator</b>	

### Nominal characteristics

Motor Ambient Temperature (°C)	40	Drive Fsw (kHz)	12
Motor Stall Torque (N.m)	1,44	Stall Current (A)	0,90
Rated Torque (N.m)	1,30	Rated Current (A)	0,8
Motor Peak Torque (N.m)	4,32	Peak Current for Drive Selection (A)	2,70
Rated Power (kW)	0,41	Kt (Nm/A)	1,60
Winding Thermal Time Constant (s)	63	Ke (V/kmin-1)	98,00
Number of Poles	6	R (ph-ph) (Ohm)	62,08
Maximum Cogging (N.m)	0,02	L (ph-ph) (mH)	114,59
Inertia (kg.cm²)	0,83	Peso del prodotto	3,32
Ingress Protection Level (IP)	IP65		

Brake	<b>Braked (6)</b>	Static Torque (N.m)	2,0
Release Time (ms)	40	Backlash (°)	0,75
Brake Supply Voltage (V)	24	Brake Coil Power (W)	11,6

### Torque / speed graph

### Configured characteristics

Motor Ambient Temperature (°C)	40
Drive Fsw (kHz)	8
Derating Factor	0,98
Stall Torque with Derating Factor (N.m)	1,41
Nominal Torque after Derating (N.m)	1,27
Peak Torque with Derating Factor (N.m)	4,32

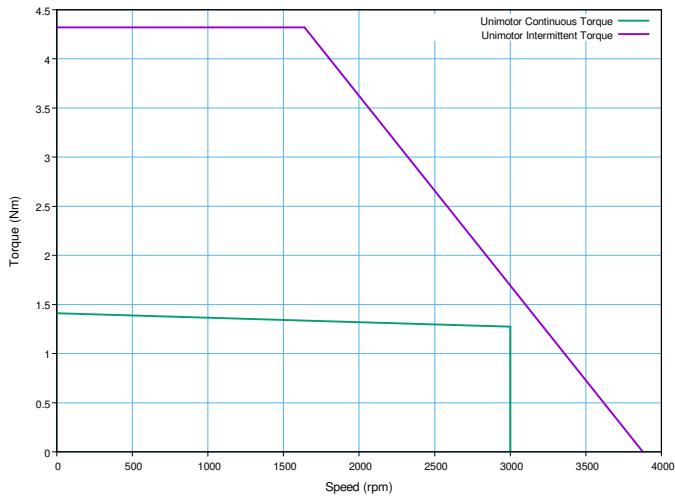
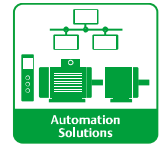
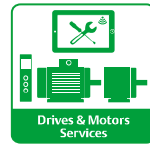
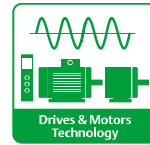

### SERVO MOTOR 075U3A306BAECA075110 - Unimotor FM 075U3A306BAECA075110

#### Motor (° & mm)

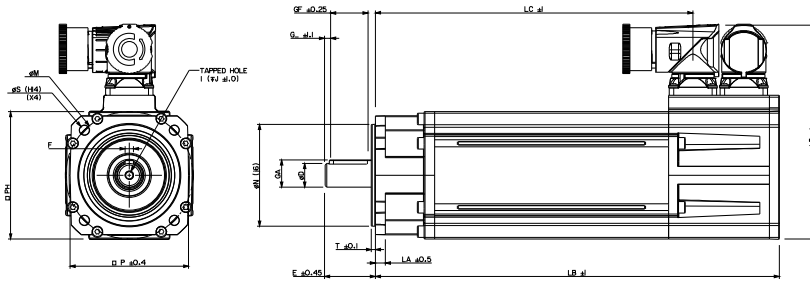

LB	Total length	238,20
LB1		
LC	Power connector position	187,20
LJ		
LA	Flange thickness	5,8
T	Register Length	2,4
N	Register Diameter	60,0
LD	Power connector overall height	135,50
LD1		
P	Flange Square	70,0
S	Fixing Hole Diameter	5,8
M	Fixing hole PCD	66,7 - 75
PH	Motor Housing Width	75
D	Shaft Diameter	11j6
E	Shaft Length	23,0
GA	Key Height	12,5
GF	Key Length	14,0
G	Key to Shaft End	3,6
F	Key Width	4
I	Tapped Hole Thread Size	M4x0.7
J	Tapped Hole Depth	11,0
	Mounting Bolt	M5

#### Motor electrical interface

Feedback device code : EC - Inductive EnDat SinCos Multi-Turn (EQI 1331)

Connection type :  
Section des fils :

B - Power and Signal 90° rotatable  
4G1 + 2x 0.5 (A)

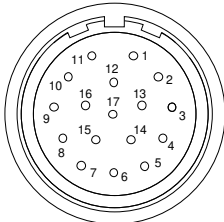

- |            |             |
|------------|-------------|
| 1 - CTP    | 10 - COS    |
| 2 - CTP    | 11 - DATA   |
| 3 - Screen | 12 - DATA / |
| -          | 13 - COS /  |
| -          | 14 - SIN    |
| -          | 15 - SIN /  |
| -          | 16 - Power  |
| 8 - CLK    | 17 - 0V     |
| 9 - CLK /  | Screen      |

- U - Phase U  
V - Phase V  
W - Phase W  
Screen

- B+ Brake +  
B- Brake -

