

SERVO MOTOR 115U3B206BBCAA115190



Definition

Type	Unimotor FM	
Frame Size (mm)	115	
Voltage	U	U - 400V
Magnet type	3	3 - Standard
Frame Length	B	
Speed (min-1)	20	2000
Brake	6	Braked (6)
Connection type	B	B - Power and Signal 90° rotatable
Output shaft	B	No Key
Feedback device code	CA	CA - 4096 ppr Incremental encoder (CFS50)
Inertia & thermistor	A	A - Standard
PCD	115	115 (FF 115 / 95)
Shaft Diameter	190	19j6 x 40,0 .
Fan box	-	
Classe d'isolation	F	
UL Motor / UL Stator	UL Motor / UL Stator	

Nominal characteristics

Motor Ambient Temperature (°C)	40	Drive Fsw (kHz)	12
Motor Stall Torque (N.m)	7,40	Stall Current (A)	3,10
Rated Torque (N.m)	7,30	Rated Current (A)	3
Motor Peak Torque (N.m)	22,20	Peak Current for Drive Selection (A)	9,25
Rated Power (kW)	1,53	Kt (Nm/A)	2,40
Winding Thermal Time Constant (s)	109	Ke (V/kmin-1)	147,00
Number of Poles	6	R (ph-ph) (Ohm)	10,68
Maximum Cogging (N.m)	0,22	L (ph-ph) (mH)	59,51
Inertia (kg.cm ²)	8,11	Peso del prodotto	11,06
Ingress Protection Level (IP)	IP65		

Brake	Braked (6)	Static Torque (N.m)	16,0
Release Time (ms)	120	Backlash (°)	0,38
Brake Supply Voltage (V)	24	Brake Coil Power (W)	23,0

Torque / speed graph



Configured characteristics

Motor Ambient Temperature (°C)	40
Drive Fsw (kHz)	8
Derating Factor	0,97
Stall Torque with Derating Factor (N.m)	7,18
Nominal Torque after Derating (N.m)	7,08
Peak Torque with Derating Factor (N.m)	22,20

SERVO MOTOR 115U3B206BBCAA115190 - Unimotor FM 115U3B206BBCAA115190

Motor (° & mm)

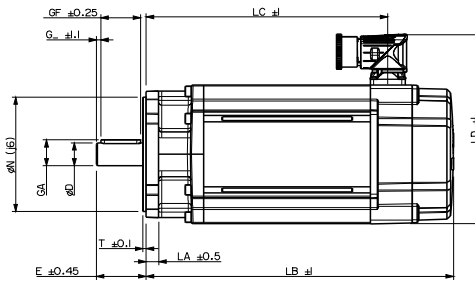
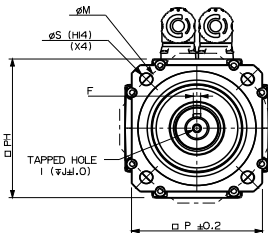

LB	Total length	306,60
LB1		
LC	Power connector position	253,80
LJ		
LA	Flange thickness	10,1
T	Register Length	2,8
N	Register Diameter	95,0
LD	Power connector overall height	156,50
LD1		
P	Flange Square	105,0
S	Fixing Hole Diameter	10,0
M	Fixing hole PCD	115
PH	Motor Housing Width	115
D	Shaft Diameter	19,6
E	Shaft Length	40,0
GA	Key Height	0,0
GF	Key Length	0,0
G	Key to Shaft End	0,0
F	Key Width	-
I	Tapped Hole Thread Size	M6x1
J	Tapped Hole Depth	17,0
	Mounting Bolt	M8

Motor electrical interface

Feedback device code : CA - 4096 ppr Incremental encoder (CFS50)

Connection type :
Section des fils :

B - Power and Signal 90° rotatable
4G1 + 2x 0.5

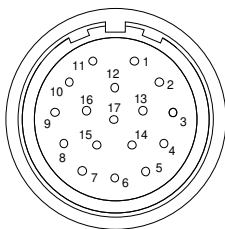

1 - CTP	10 - A
2 - CTP	11 - Index
3 -	12 - Index /
4 - S1	13 - A /
5 - S1 /	14 - B
6 - S2	15 - B /
7 - S2 /	16 - Power
8 - S3	17 - 0V
9 - S3 /	Screen

U - Phase U
V - Phase V
W - Phase W
Screen

B+ Brake +
B- Brake -

