

SERVO MOTOR 115U3E300BAECA115240



Definition

| | | |
|----------------------|---|--------------|
| Type | Unimotor FM | |
| Frame Size (mm) | 115 | |
| Voltage | U | U - 400V |
| Magnet type | 3 | 3 - Standard |
| Frame Length | E | |
| Speed (min-1) | 30 | 3000 |
| Brake | 0 Unbraked (0) | |
| Connection type | B B - Power and Signal 90° rotatable | |
| Output shaft | A | Key |
| Feedback device code | EC EC - Inductive EnDat SinCos Multi-Turn (EQI 1331) | |
| Inertia & thermistor | A A - Standard | |
| PCD | 115 115 (FF 115 / 95) | |
| Shaft Diameter | 240 24j6 x 50,0 . | |
| Fan box | - | |
| Classe d'isolation | F | |
| UL Motor / UL Stator | UL Motor / UL Stator | |

Nominal characteristics

| | | | |
|-----------------------------------|-------|--------------------------------------|-------|
| Motor Ambient Temperature (°C) | 40 | Drive Fsw (kHz) | 12 |
| Motor Stall Torque (N.m) | 16,00 | Stall Current (A) | 10,00 |
| Rated Torque (N.m) | 12,70 | Rated Current (A) | 7,9 |
| Motor Peak Torque (N.m) | 48,00 | Peak Current for Drive Selection (A) | 30,00 |
| Rated Power (kW) | 3,99 | Kt (Nm/A) | 1,60 |
| Winding Thermal Time Constant (s) | 141 | Ke (V/kmin-1) | 98,00 |
| Number of Poles | 6 | R (ph-ph) (Ohm) | 1,23 |
| Maximum Cogging (N.m) | 0.21 | L (ph-ph) (mH) | 9,89 |
| Inertia (kg.cm ²) | 14,80 | Peso del prodotto | 14,02 |
| Ingress Protection Level (IP) | IP65 | | |

Torque / speed graph

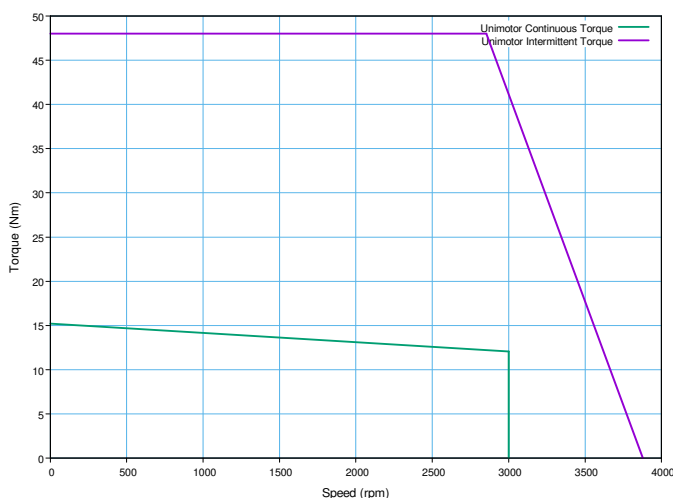

Configured characteristics

| | |
|---|-------|
| Motor Ambient Temperature (°C) | 40 |
| Drive Fsw (kHz) | 8 |
| Derating Factor | 0,95 |
| Stall Torque with Derating Factor (N.m) | 15,20 |
| Nominal Torque after Derating (N.m) | 12,06 |
| Peak Torque with Derating Factor (N.m) | 48,00 |

SERVO MOTOR 115U3E300BAECA115240 - Unimotor FM 115U3E300BAECA115240

Motor (° & mm)

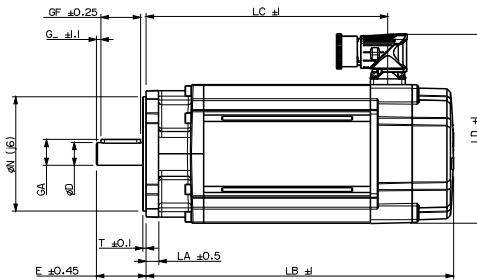
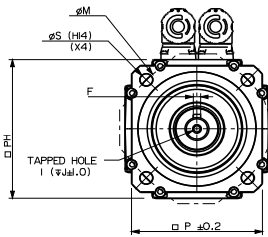

| | | |
|-----|--------------------------------|---------|
| LB | Total length | 353,60 |
| LB1 | | |
| LC | Power connector position | 313,80 |
| LJ | | |
| LA | Flange thickness | 10,1 |
| T | Register Length | 2,8 |
| N | Register Diameter | 95,0 |
| LD | Power connector overall height | 156,50 |
| LD1 | | |
| P | Flange Square | 105,0 |
| S | Fixing Hole Diameter | 10,0 |
| M | Fixing hole PCD | 115 |
| PH | Motor Housing Width | 115 |
| D | Shaft Diameter | 24j6 |
| E | Shaft Length | 50,0 |
| GA | Key Height | 27,0 |
| GF | Key Length | 40,0 |
| G | Key to Shaft End | 4,6 |
| F | Key Width | 8 |
| I | Tapped Hole Thread Size | M8x1,25 |
| J | Tapped Hole Depth | 20,0 |
| | Mounting Bolt | M8 |

Motor electrical interface

Feedback device code : EC - Inductive EnDat SinCos Multi-Turn (EQI 1331)

Connection type :
Section des fils :

B - Power and Signal 90° rotatable
4G1 (A)

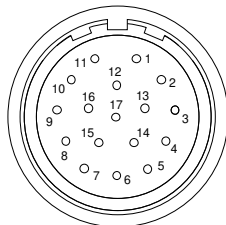

- | | |
|------------|-------------|
| 1 - CTP | 10 - COS |
| 2 - CTP | 11 - DATA |
| 3 - Screen | 12 - DATA / |
| - | 13 - COS / |
| - | 14 - SIN |
| - | 15 - SIN / |
| 8 - CLK | 16 - Power |
| 9 - CLK / | 17 - 0V |
| | Screen |

- U - Phase U
V - Phase V
W - Phase W
Screen

- B+ Brake +
B- Brake -

